

1 PELHAM COURT, SW3

APPROX. GROSS INTERNAL AREA *

247 Ft² - 22.95 M²

ILLUSTRATION FOR IDENTIFICATION PURPOSES ONLY. NOT TO SCALE

* As Defined by RICS - Code of Measuring Practice

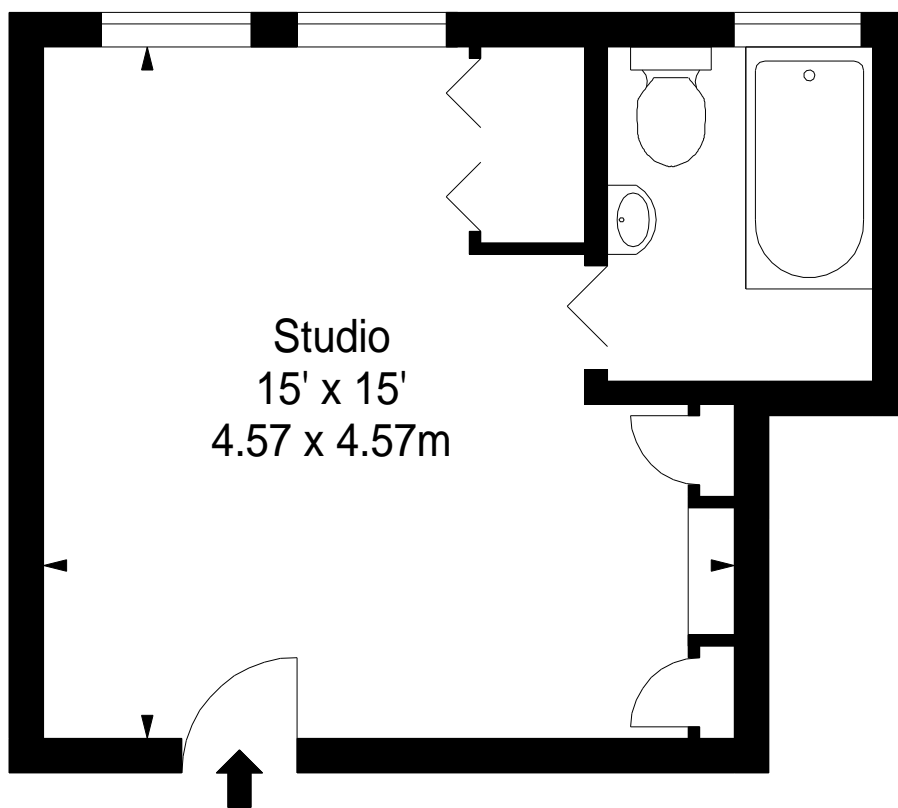

LOWER GROUND FLOOR

B K R

www.bkrfloorplans.co.uk

T: 0845 257 2023

© BKR 2010