



Metro Central Heights

119 Newington Causeway London SE1 6DQ

- First floor
- Long Lease
- Grade II listed building
- Residents gym and swimming pool
- Elephant & Castle stations minutes away
- Two double bedrooms
- No onward chain
- 24 hour concierge
- Well maintained communal areas
- Bars and restaurants nearby

Offers Over £375,000

Metro Central Heights

119 Newington Causeway London SE1 6DQ



For sale with no onward chain is this first floor apartment within the iconic Metro Central Heights a gated development complex on the east side of the Elephant & Castle junction which offers its residents access to an onsite gym, indoor swimming pool, jacuzzi and 24 hour concierge service.

The 54 sqm property, which is offered with a long lease, briefly comprises an entrance hall, reception room which is open plan to a fitted kitchen with integrated appliances, two double bedrooms of equal size and a tiled bathroom.

Grade II listed Metro Central Heights on Newington Causeway is a group of residential buildings constructed in the 1960's and converted to form over 400 studio to three bedroom properties for residential use in 1997. Elephant and Castle underground (Bakerloo and Northern lines) and overground (Thameslink) stations are just a few minutes walk away as is a Sainsbury's on New Kent Road, a good choice of bars and restaurants in newly created Elephant Park whilst pleasant open space can be enjoyed in nearby Newington Gardens.



Directions



Floor Plan



Metro Central Heights, Newington Causeway, SE1

GROSS INTERNAL AREA
53.6 sq m / 576 sq ft

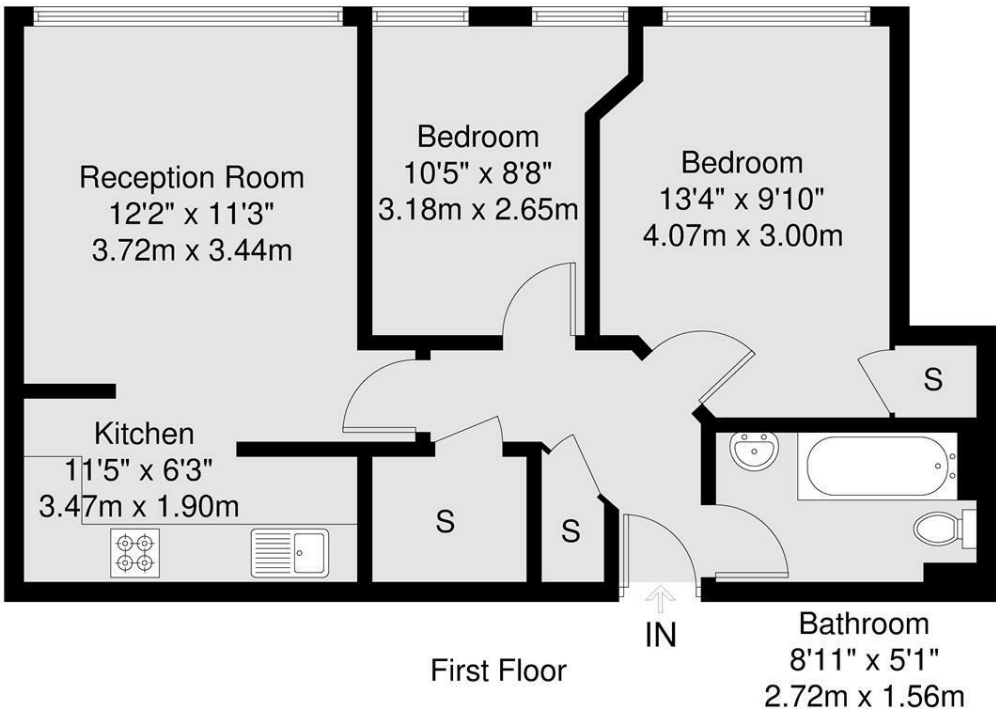

GROSS INTERNAL AREA (GIA)
The footprint of the property
53.6 sq m / 576 sq ft

TOTAL STORAGE SPACE
Storage and wardrobe total area
3.4 sq m / 36 sq ft

EXTERNAL STRUCTURAL FEATURES
Garden, Balcony, Terrace, Verandah etc.
0.0 sq m / 0.0 sq ft

RESTRICTED HEAD HEIGHT
Limited use area under 1.5m
0.0sq m / 0.0 sq ft

Disclaimer : Floorplan measurements are approximate and are for illustrative purposes only. While we do not doubt the floorplan accuracy and completeness, you or your advisors should conduct a careful, independent investigation of the property in respect of monetary valuation.

Maison
VUE

These particulars, whilst believed to be accurate are set out as a general outline only for guidance and do not constitute any part of an offer or contract. Intending purchasers should not rely on them as statements of representation of fact, but must satisfy themselves by inspection or otherwise as to their accuracy. No person in this firms employment has the authority to make or give any representation or warranty in respect of the property.

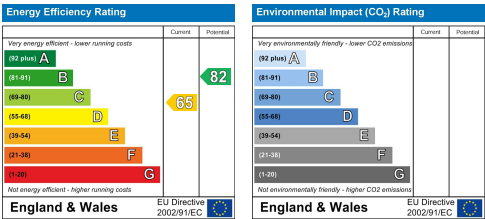

48 Warwick Street Soho, London, W1B 5NL
Tel: 020 7287 4244 Email: enquiries@outlet.co.uk <https://www.outletresidential.co.uk>